

CAPACITY: 130 GALLONS  
 APPROXIMATE DRY WEIGHT: 1,800LB  
 FILLED WEIGHT: 2,840LB

PLAN

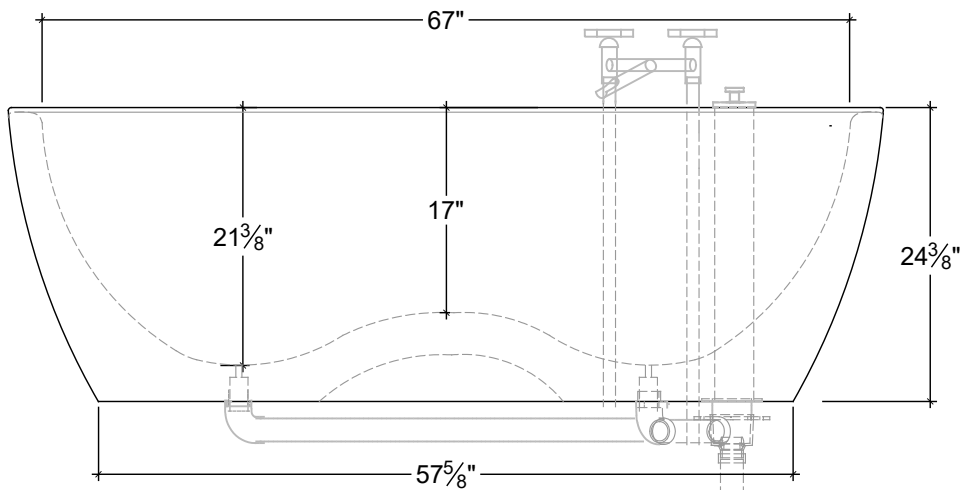

FRONT ELEVATION

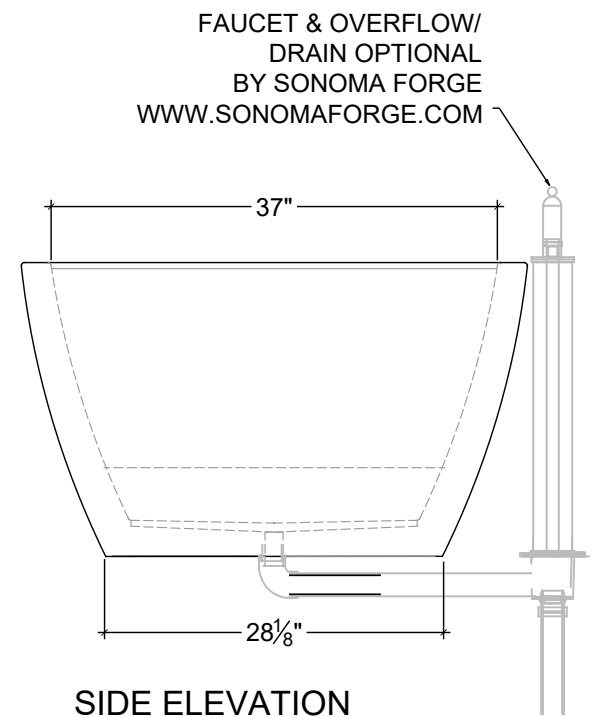

SIDE ELEVATION

FAUCET & OVERFLOW/  
 DRAIN OPTIONAL  
 BY SONOMA FORGE  
 WWW.SONOMAFORGE.COM

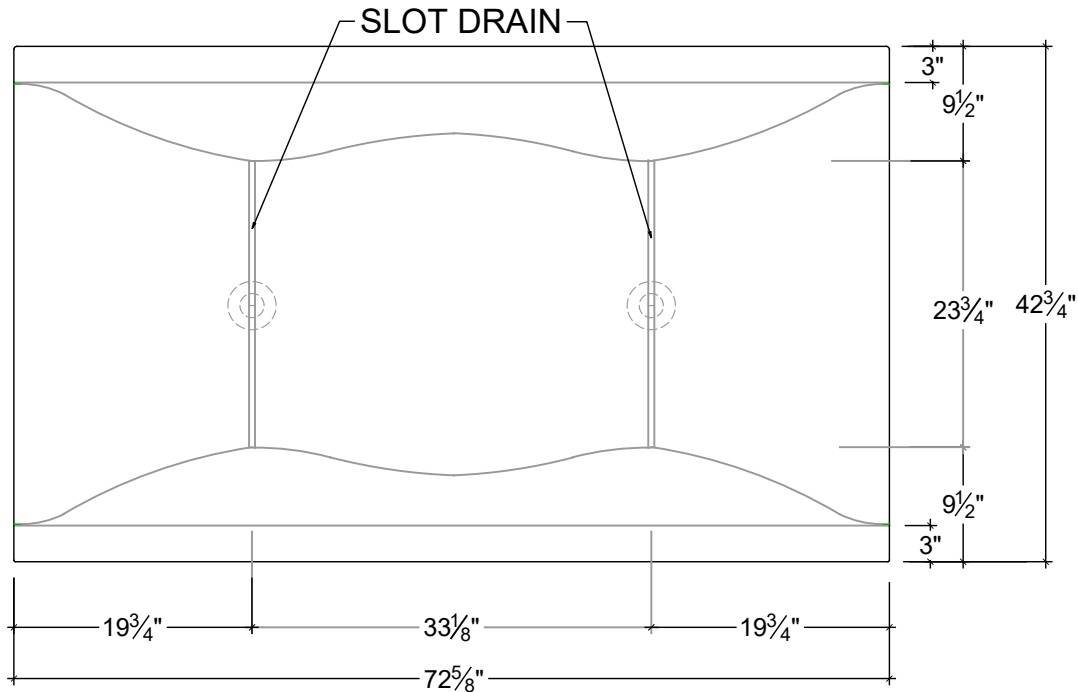

PLAN

CAPACITY: 130 GALLONS  
 APPROXIMATE DRY WEIGHT: 2,300LB  
 FILLED WEIGHT: 3,340LB

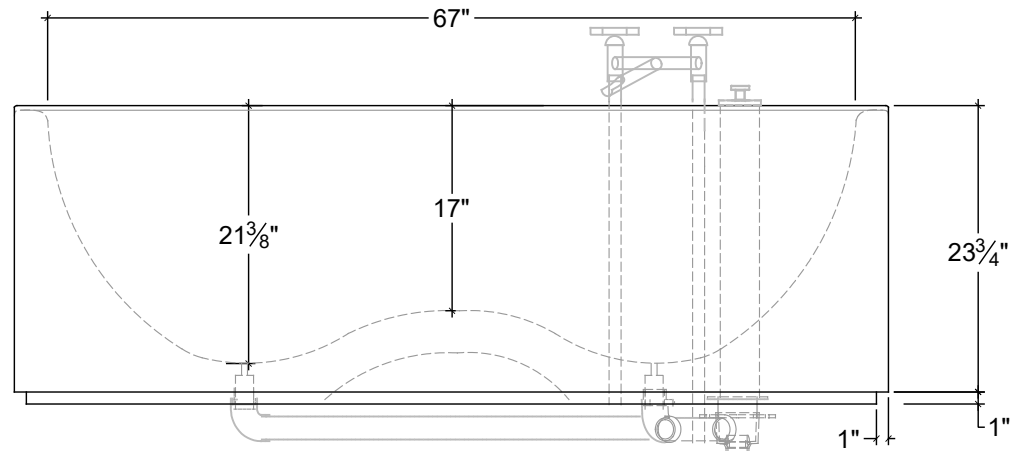

FRONT ELEVATION

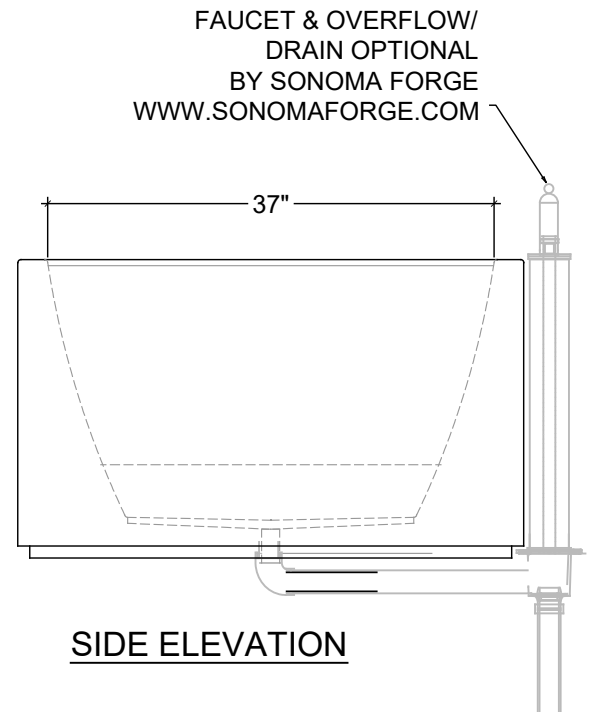

SIDE ELEVATION

FAUCET & OVERFLOW/  
 DRAIN OPTIONAL  
 BY SONOMA FORGE  
 WWW.SONOMAFORGE.COM

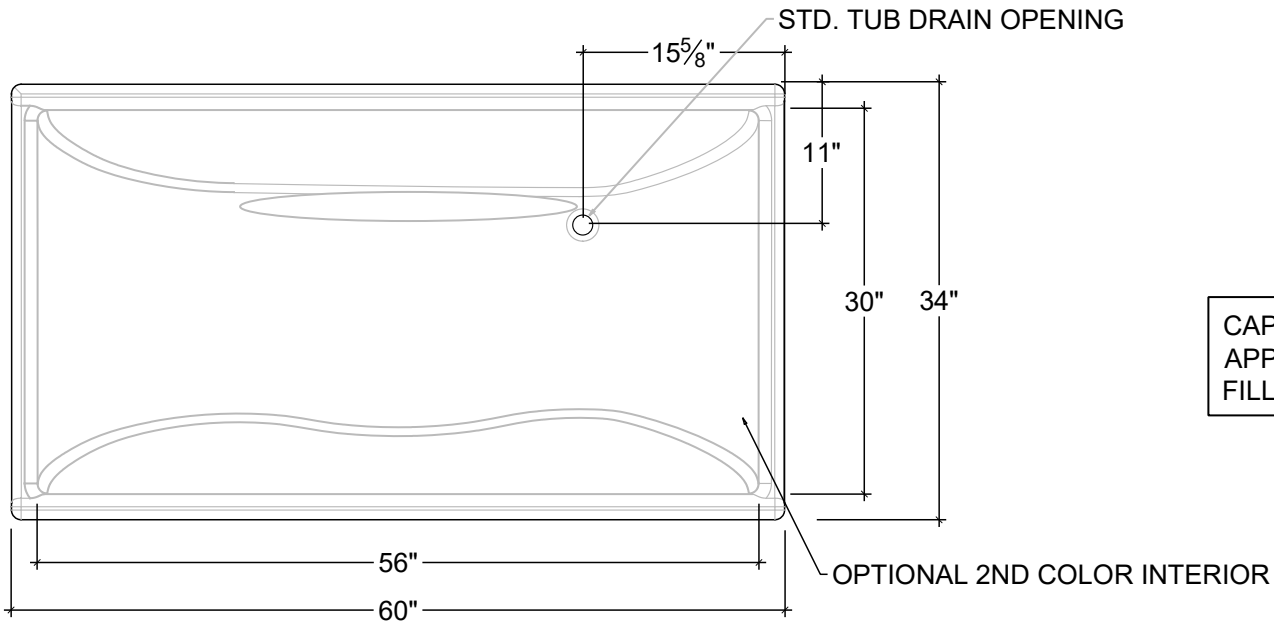

CAPACITY: 85 GALLONS (3" FROM RIM)  
 APPROXIMATE DRY WEIGHT: 800LB.  
 FILLED WEIGHT 1,480LB

PLAN

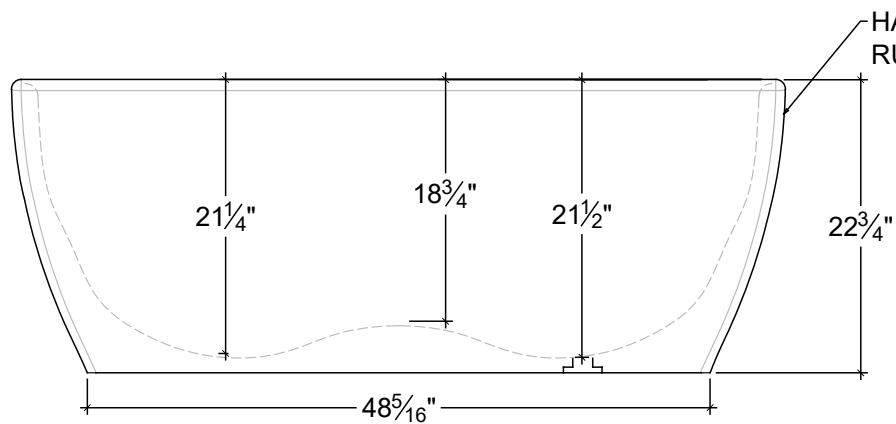

FRONT ELEVATION

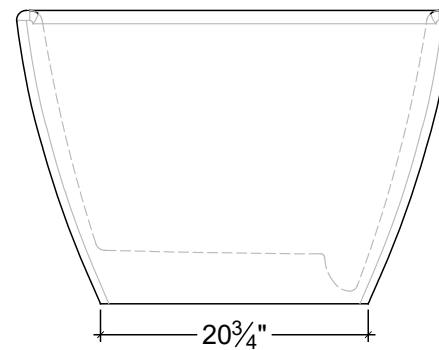

SIDE ELEVATION

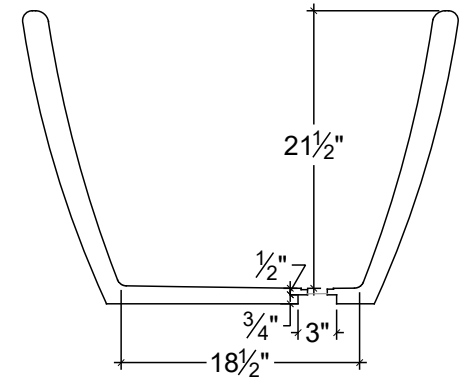

SECTION @ DRAIN

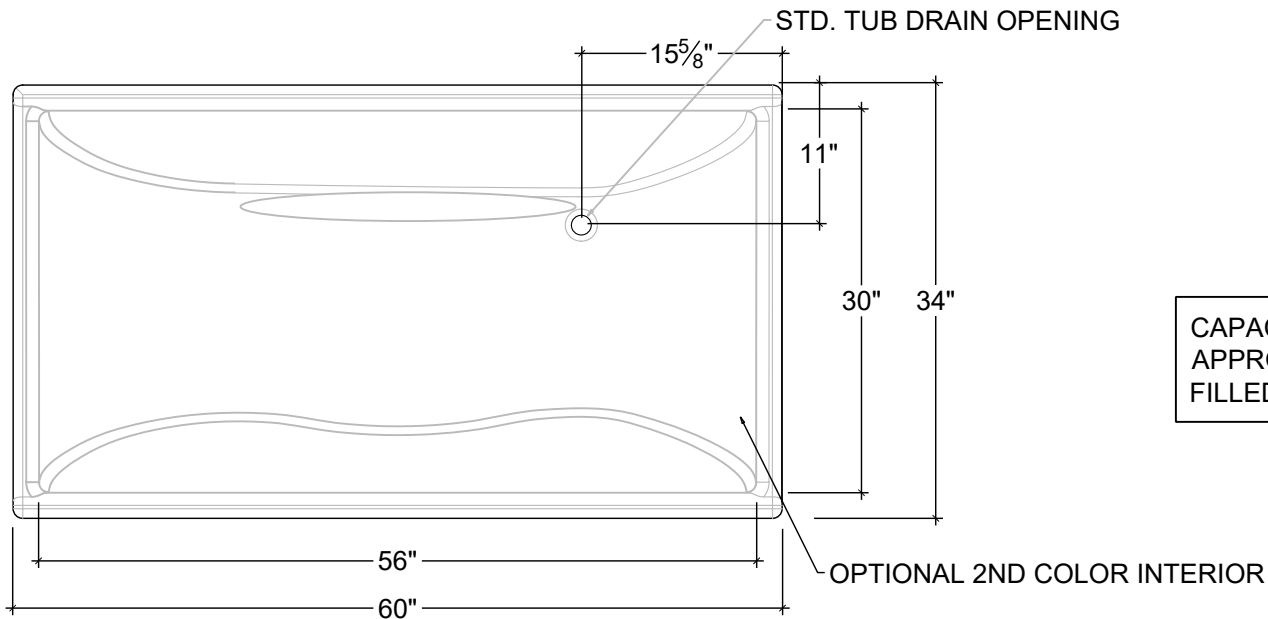

CAPACITY: 85 GALLONS  
 APPROXIMATE DRY WEIGHT: 1,580LB.  
 FILLED WEIGHT: 2,260

PLAN

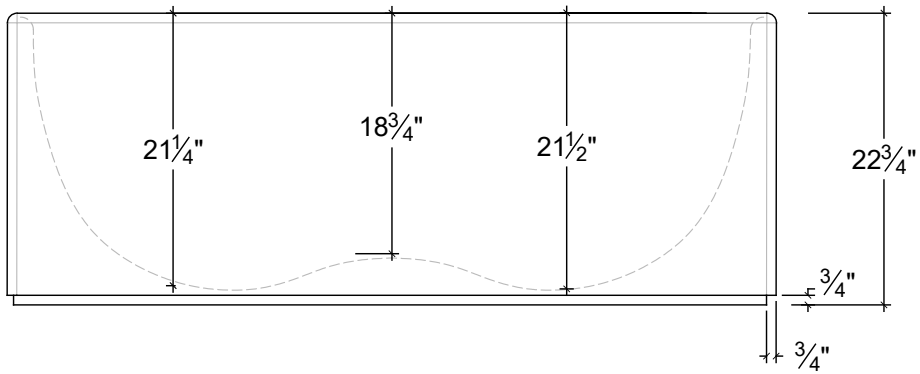

FRONT ELEVATION

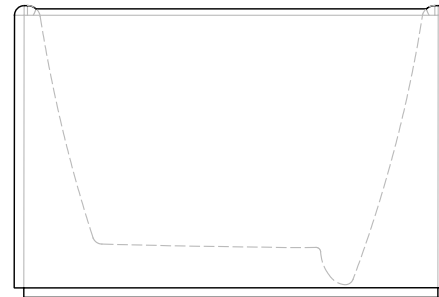

SIDE ELEVATION

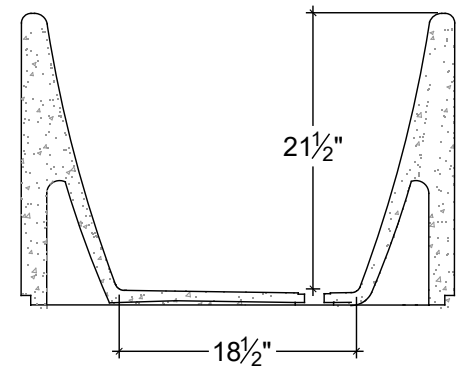

SECTION @ DRAIN

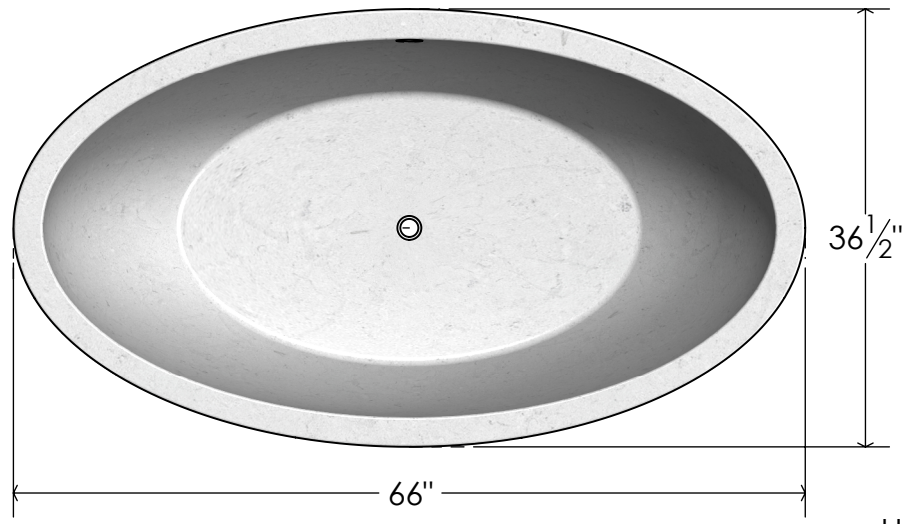

HANDFINISHED  
NATURAL EXTERIOR  
-OPTIONAL METALCRETE FINISH-

WEIGHT: 687LB EMPTY; 1,319LB FULL  
CAPACITY: 79 GAL. TO OVERFLOW

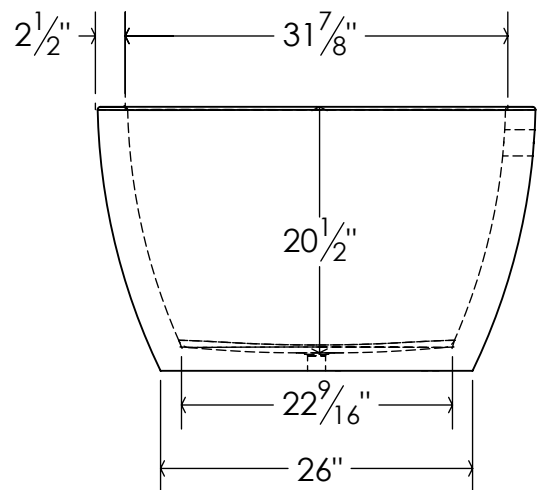
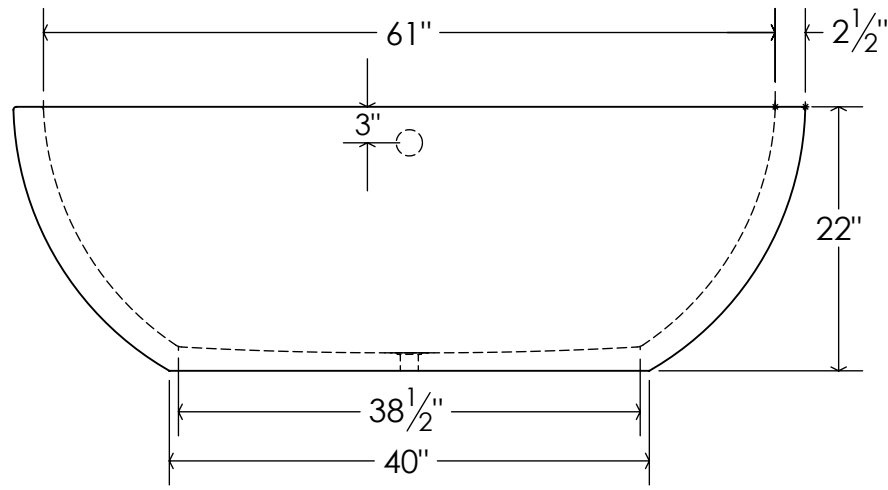

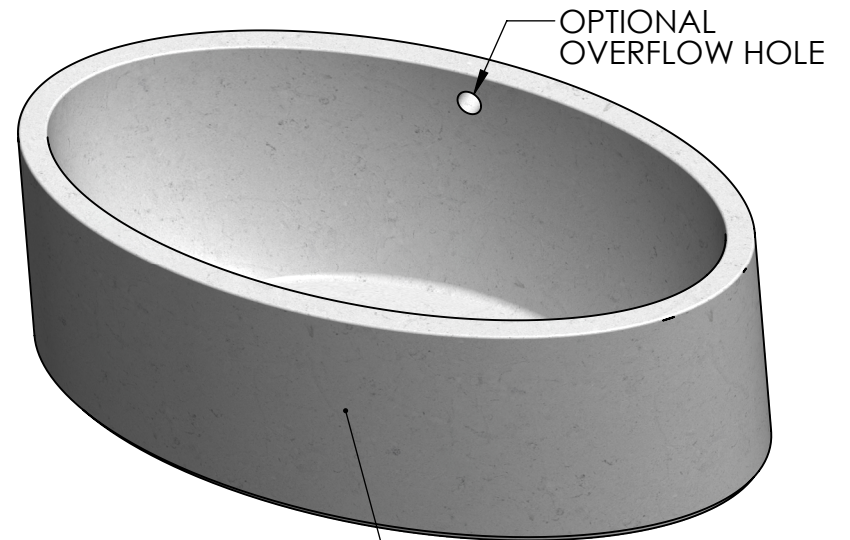
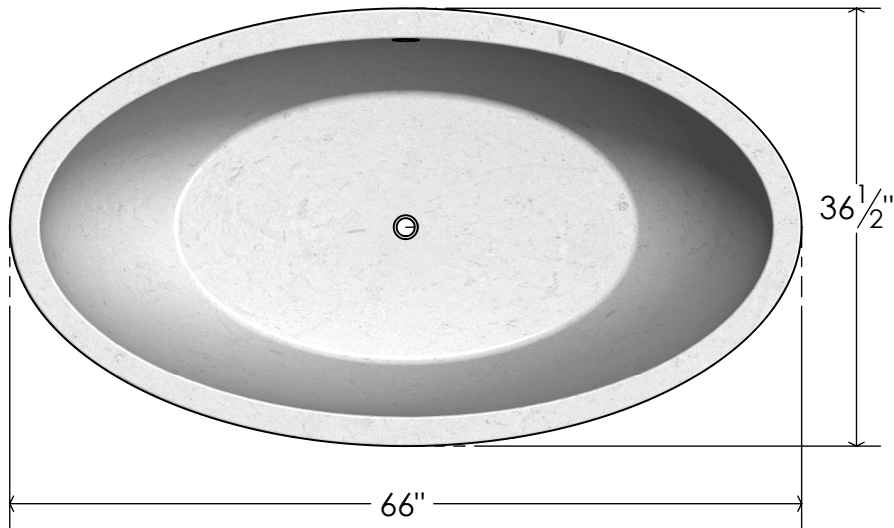

WEIGHT: 967LB EMPTY; 1,599LB FULL  
CAPACITY: 74 GAL. TO OVERFLOW

SMOOTH CAST EXTERIOR  
-OPTIONAL METALCRETE FINISH-

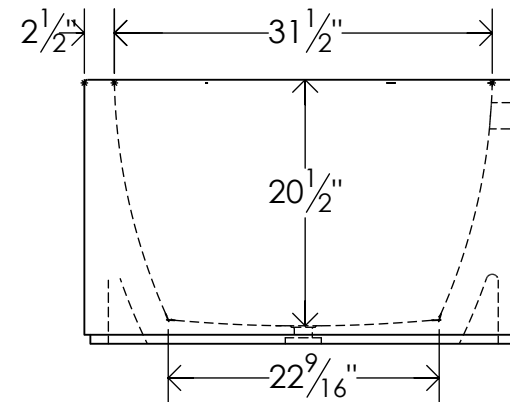
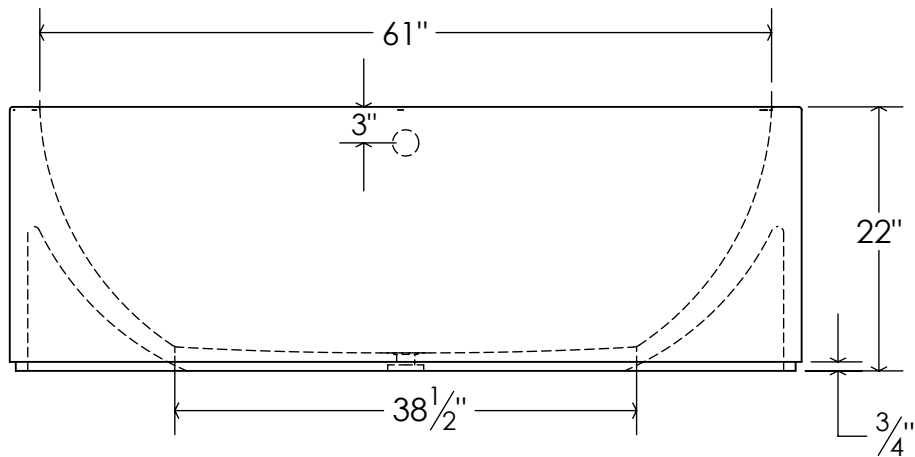

## FULLY PLATED BRASS WASTE &amp; OVERFLOW

## SPECIFICATIONS

## STANDARD FINISHES

BRN – BRUSHED NICKEL  
 CHBRZ – CHAMPAGNE BRONZE  
 CPB – POLISHED CHROME  
 MB – MATTE BLACK  
 PN – POLISHED NICKEL

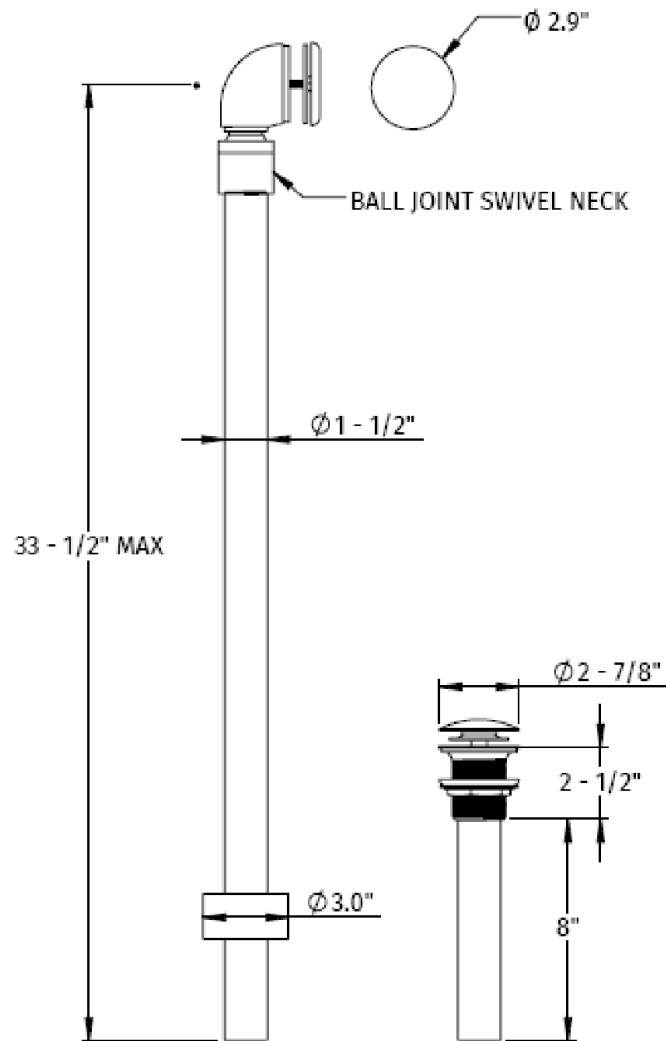

- ALL BRASS FITTINGS AND 17 GAUGE TUBE
- FULLY POLISHED AND PLATED FOR EXPOSED APPLICATIONS
- PIPE LENGTH CAN BE CUT TO FIT TUB **\*TEST FIT BEFORE CUTTING\***
- CONTEMPORARY STYLING WITH EZ CLICK™ DRAIN
- SWIVELING OVERFLOW NECK ADJUSTS TO FIT BATHTUB WALL
- 1 1/2" O.D. BRASS TAILPIECE
- FOR USE WITH 2" DRAIN AND OVERFLOW OPENINGS

FOR CONVENTIONAL DRAIN TUBS ONLY  
 (NOT DOUBLE WAVE TUB OR OFURO)

ALSO AVAILABLE AS DRAIN ONLY.

IF ORDERING OVERFLOW, PLEASE SPECIFY TUB HOLE LOCATION.

CAPACITY: 70 GALLONS  
 APPROXIMATE DRY WEIGHT: 1,100LB  
 FILLED WEIGHT: 1,660LB

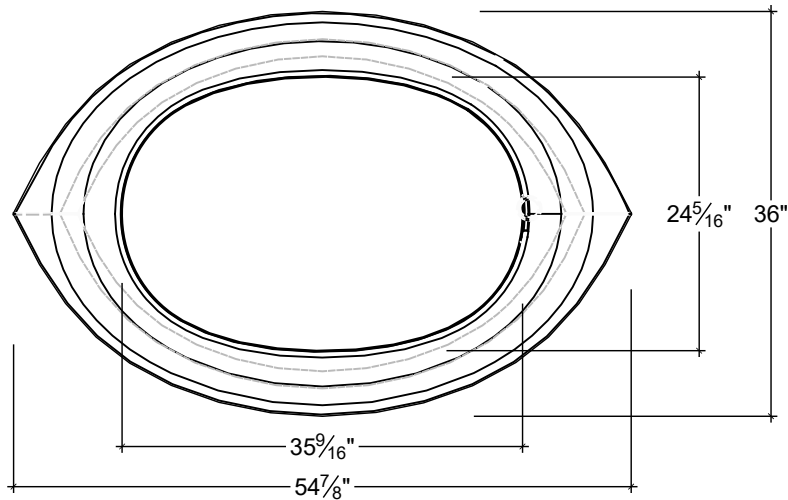

PLAN

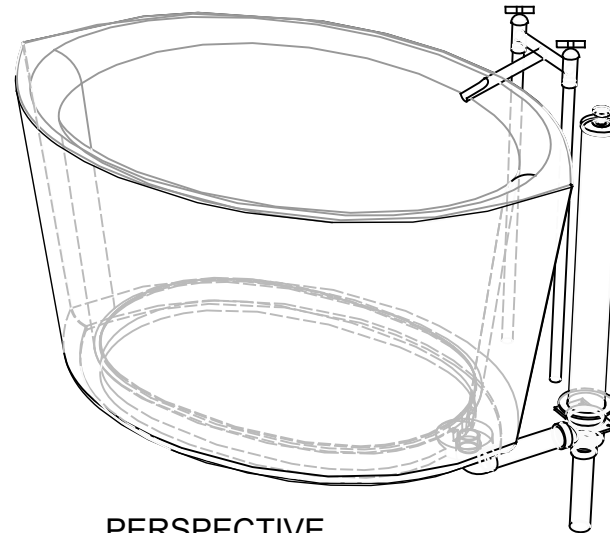

PERSPECTIVE

FAUCET & OVERFLOW/ DRAIN  
 OPTIONAL BY SONOMA FORGE  
[WWW.SONOMAFORGE.COM](http://WWW.SONOMAFORGE.COM)

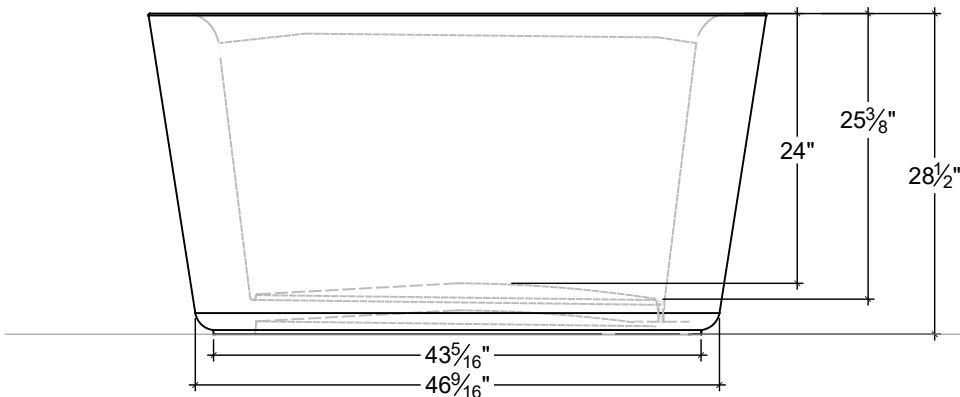

ELEVATION

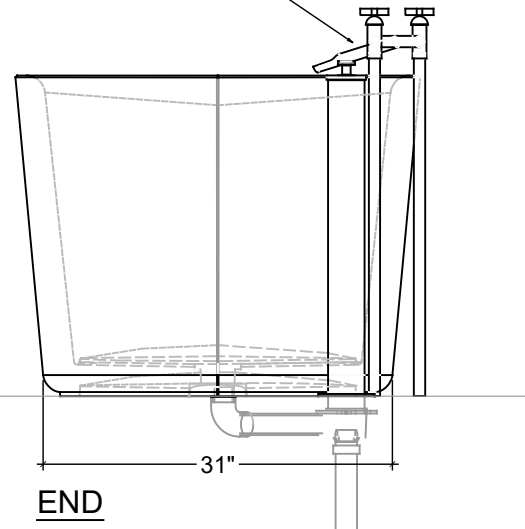

END



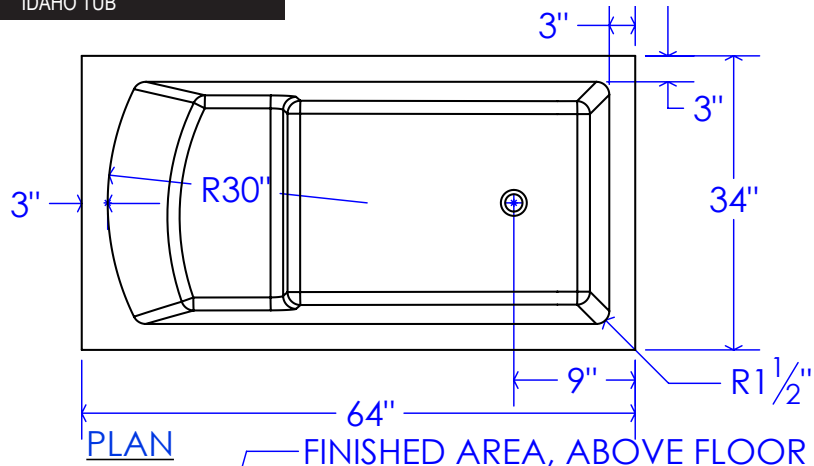

PLAN

FINISHED AREA, ABOVE FLOOR

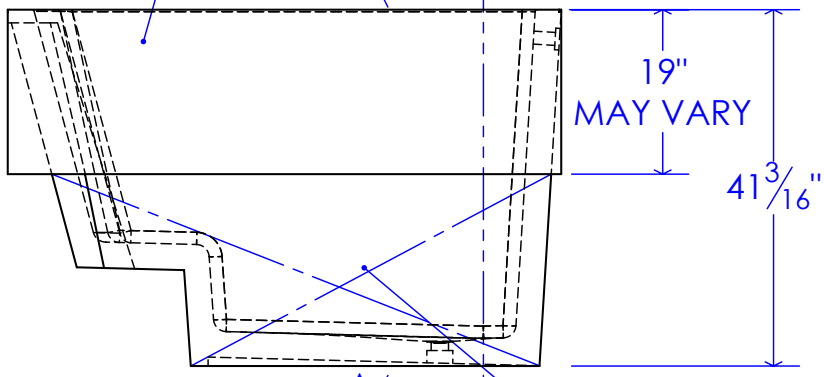

FRONT ELEVATION

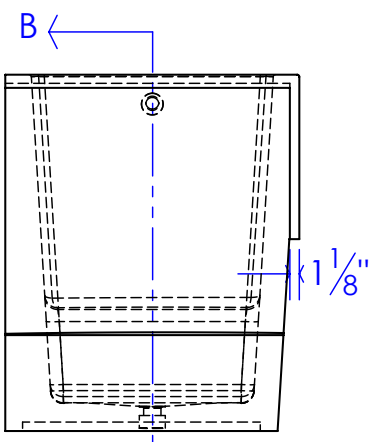

LEFT ELEVATION

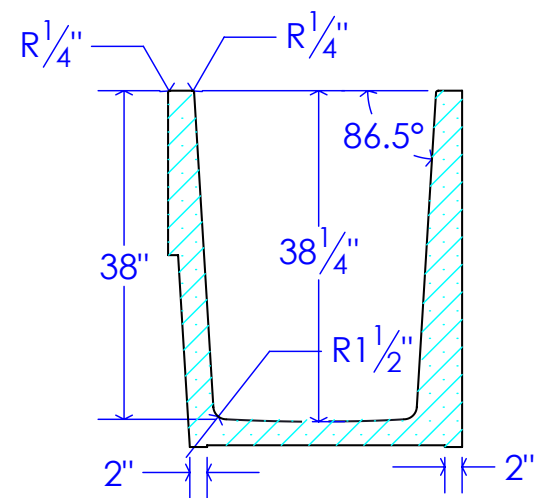

SECTION A-A

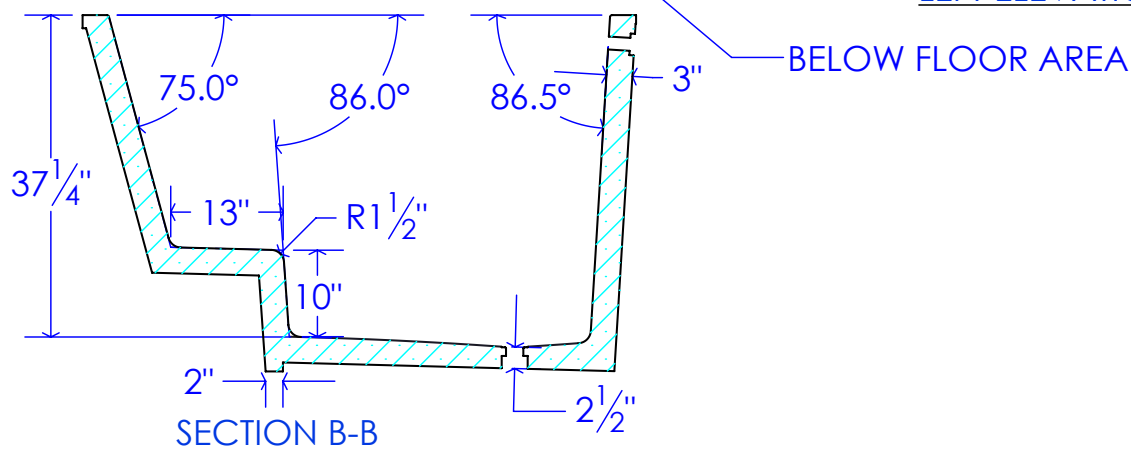

SECTION B-B