

B: 5 1/2" MIN. FOR DECK-MOUNT FAUCET.
2" MIN. FOR WALL-MOUNT FAUCET.

A: 2" MIN., 3 1/2+ IF SINK IS TO FIT INTO CABINET

PLAN

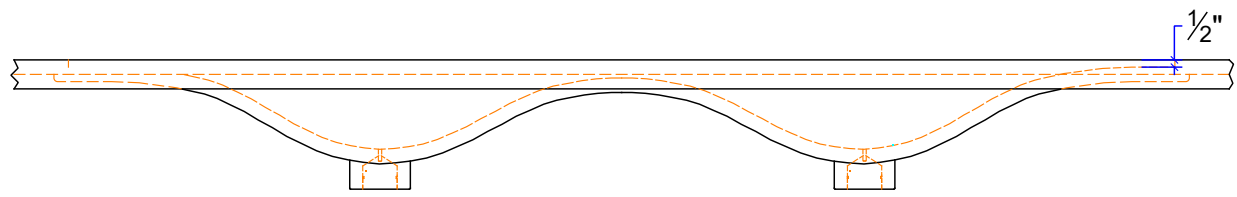

FRONT ELEVATION, STD. EDGE

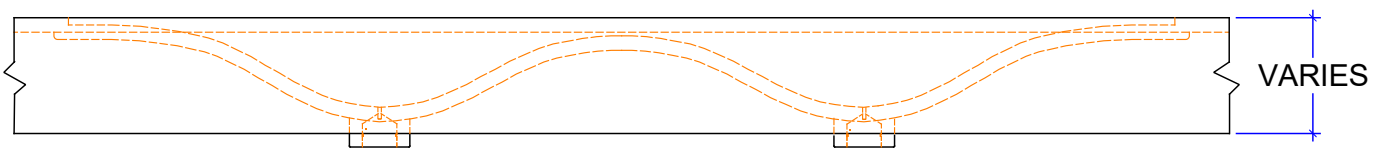

FRONT ELEVATION, EXTENDED FRONT APRON

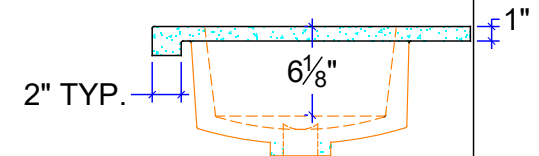

SECTION BEYOND SINK

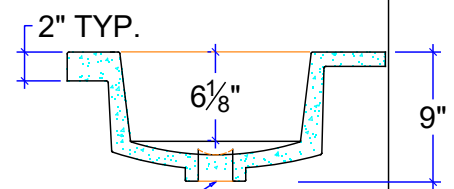

SECTION @ DRAIN

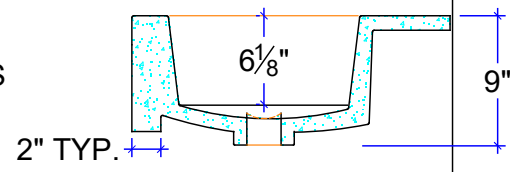

SECTION @ DRAIN

CUSTOM SIZE COUNTERTOP WITH FIXED SIZE BASIN. DIMENSIONS ARE INSIDE SINK.