



STANDARD PRODUCTS

SONOMA CAST STONE CORPORATION
 Makers of NuCrete™, The World's Only Stainless Concrete
 877.283.1897 • www.sonomastone.com



For more product info, or to download replacement forms, see: www.sonomastone.com

CounterTile™ CNTILES CNTILE-SPLSH

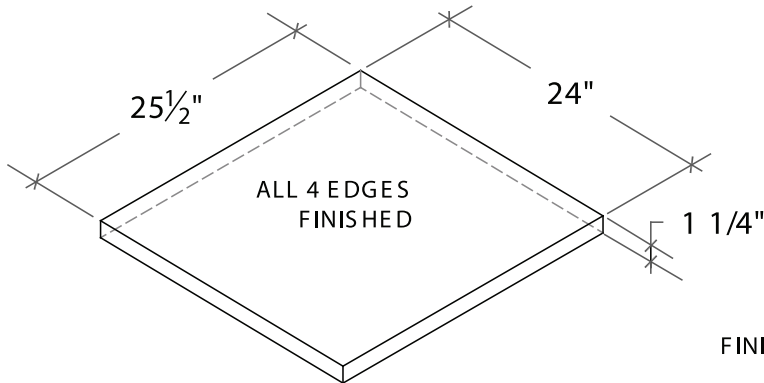

STANDARD TILE

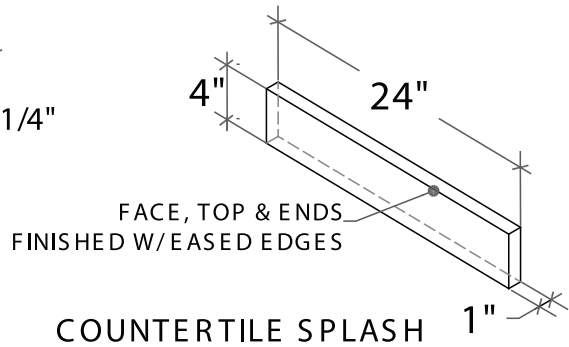

COUNTERTILE SPLASH

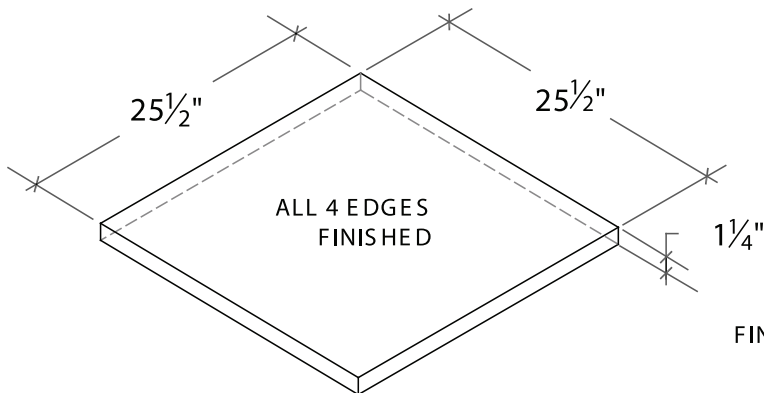

CORNER TILE

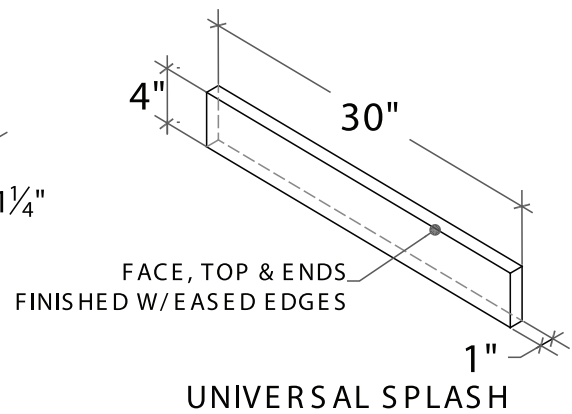

UNIVERSAL SPLASH

Designs ©2007 Sonoma Cast Stone Corp. All rights reserved.

Visit www.sonomastone.com to see photos of this and other products.

• DESCRIPTION

CounterTiles™ offer the look and feel of concrete in the Kitchen at a fraction of the cost. The tiles are easy to install. A modular system consisting of a standard size tile to create running lengths of countertop. Optional matching splash available. To create a simple L-Shape, special corner tiles and splash are available. All items are standard in Stainless NuCrete™. To install, CounterTiles should be adhered to the cabinet frame with a silicone bead. Seams may be spread and grouted or butted and secured with color matched silicone bead. Tiles may be field cut for length only with wet tile saw.

Several sink options complete the system. A special tile also accommodates an undermount sink option. Call for recommended sizes and models.

• FACTS

Stainless NuCrete™. 24 standard colors. See: www.sonomastone.com, catalog or techbinder. Custom colors available. Order samples online, or call 877-283-2400 x113.

Finished Top and all four Sides with eased edges. Steel reinforcing bars are located 2" from perimeter. Caution if field drilling for faucet holes.

Field cuts for lengths accomplished with wet tile saw.

Approximate Weight: 60 lbs