

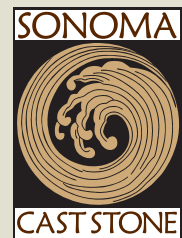

Ofuro

This breathtakingly beautiful bathroom sculpture is an homage to the Japanese traditional soaking tub. There are no words to describe the sensation of unwinding in this solid, concrete delight. Simple put, the Ofuro tub will enhance your quality of life.

Available in 24 natural and designer colors to match your bathroom décor. An optional, programmable heating coil can be cast into body of the tub, for those days you just don't want to get out.



Sonoma Cast Stone
makes the finest concrete
in the world.

Custom Countertops
Sinks for the Kitchen & Bath
Fireplace Surrounds
Tiles and Pavers

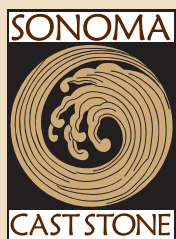

Ofuro

The Japanese Soaking Tub from Sonoma Cast Stone



DoubleWave Tub

The shape that makes you say, "Ah..." Let this magnificent and unique, concrete soaking tub be your ship of dreams, and drift away. The contours make it comfortable even without water, and the optional, embedded heating coil will maintain water temperature indefinitely, for those times when you simply don't want to get out.

Roomy enough for two ecstatic passengers.

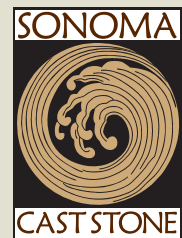

Sonoma Cast Stone
makes the finest concrete
in the world.

Custom Countertops
Sinks for the Kitchen & Bath
Fireplace Surrounds
Tiles and Pavers



Double Wave Tub

Say "Ahhh...."



STANDARD PRODUCTS

SONOMA CAST STONE CORPORATION
877.283.2400 • www.sonomastone.com



For more product info, or to download replacement forms, see: www.sonomastone.com

Ofuro Japanese Soaking Tub OFURO

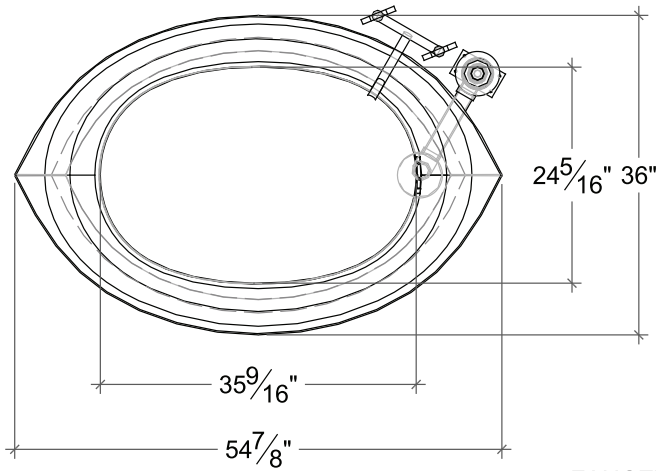

PLAN

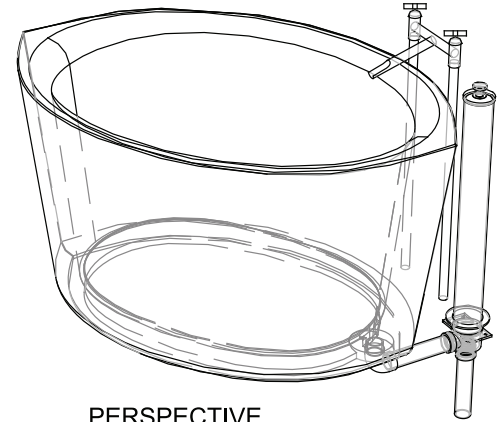

PERSPECTIVE

FAUCET & OVERFLOW/ DRAIN
OPTIONAL BY SONOMA FORGE
WWW.SONOMAFORGE.COM

For remodel applications, platform framing may be necessary to accommodate plumbing. capacity: 70 gallons

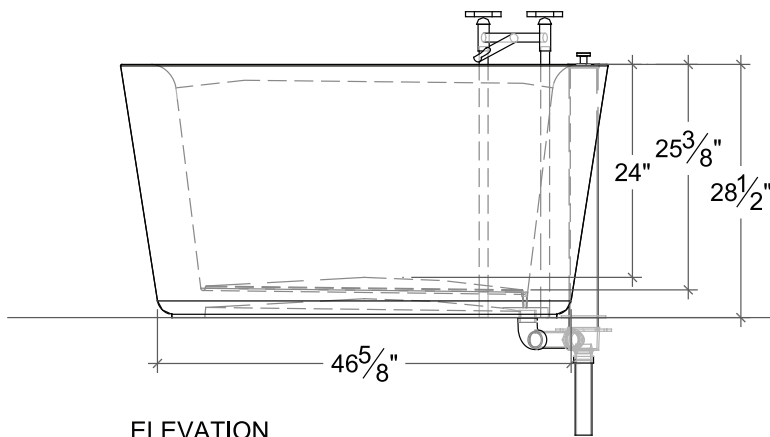

ELEVATION

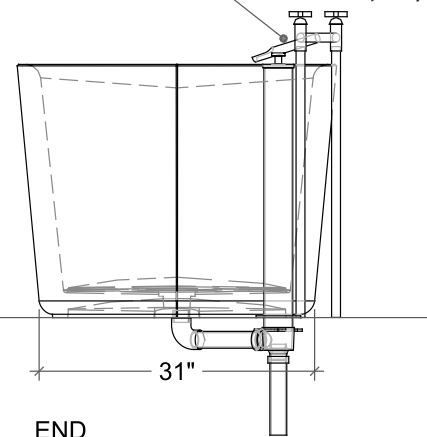

END

Designs ©2007 Sonoma Cast Stone Corp. All rights reserved.

Visit www.sonomastone.com to see photos of this and other products.



• DESCRIPTION

The Ofuro is a Japanese-style soaking tub designed for one. This beautiful stand alone tub has been called more of a piece of sculpture than a bathtub. An optional heating element can be embedded into the concrete to insure an even and constantly warm surface that will maintain the hot water until all of your daily woes are forgotten. The heating option includes a programmable timer that will control both the times and temperature of the tub surface. This 865 lb tub requires careful planning with an architect or structural engineer. Primarily designed for new construction, however, retrofit options are possible. An installation brochure should be requested and studied to insure that proper plumbing and electrical connections are in the proper placement before the floor is constructed. Sonoma Forge has designed a tub filler and a combination drain and overflow assembly to match this tub.

• FACTS

24 standard colors. See: www.sonomastone.com, catalog or techbinder. Custom colors available. Order samples online, or call 877-283-2400 x113.

Requires separate tub filler (wall or floor-mounted to side) for pre-mixed water with remote mixing valve (from Sonoma Forge and others). 70 gallon capacity. Tub may be floor-mounted or on pedestal (raised floor) in remodel applications. The slot drain couple to conventional 1 1/2" drain assemblies. 1-1/2" diameter ABS pipe stub-out included. 1-1/2" drain pipe must be accompanied with remote overflow & drain assembly (available from Sonoma Forge and others). Drain is best accomplished before floor is poured and completed. Perimeter drain replaces traditional drain assembly so there is no visible hardware.

For UPC (IAPMO) listing, see Appendix, p08-10.

Approximate Weight: 1,124 lbs / Crated 1,474 lbs

SEE WWW.SONOMASTONE.COM FOR PHOTOS AND ADDITIONAL INFORMATION ON THIS PRODUCT



INSTALLATION

SONOMA CAST STONE CORPORATION
(877) 283-2400 www.sonomastone.com



For more product info, or to download replacement forms, see: www.sonomastone.com

Ofuro Japanese Soaking Tub OFURO

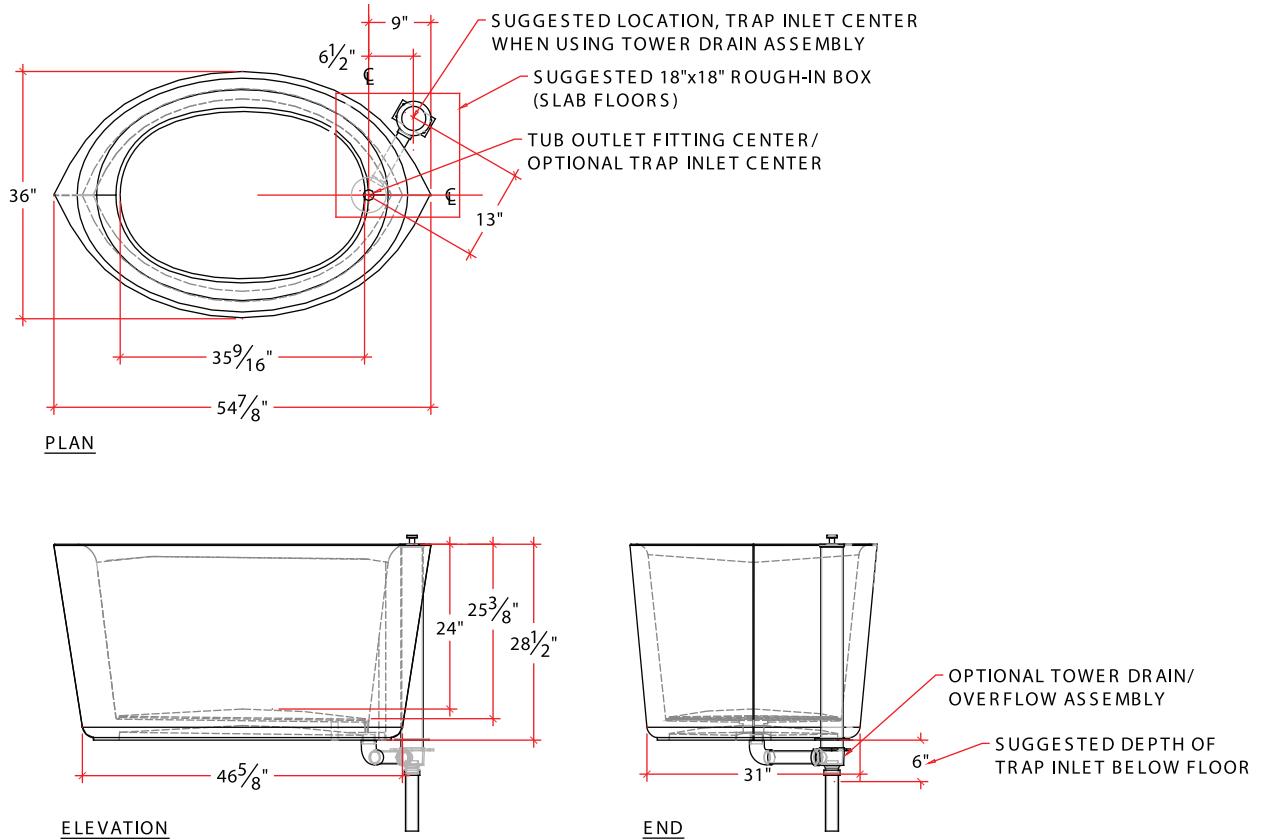

Designs © Sonoma Cast Stone Corp. 2007. All rights reserved.

This is a general guide. Installations may vary according to site conditions. Plumbing connections should be made by a qualified plumber, following all applicable code requirements. Please see Ofuro Specification sheet for complete dimension information.

1. Make sure the floor structure will not deflect due to the weight of the tub. The Ofuro with hardware, filled with water and a bather, will weigh app. 1440 lbs.
2. Plan the trap location using the diagrams below as a guide. For slab floors, a bathtub rough-in box is needed for drain connections. For wood-frame floors, below-floor access will simplify connections.
3. The Ofuro is provided with an integral 1" ABS drain coupling. The installer should use ABS cement to glue in a pipe stub of the appropriate length to connect to the trap, or to the optional tower drain/ overflow assembly.
4. If using the Sonoma Forge Tower Drain/ overflow assembly, follow the manufacturer's instructions for connection. If connecting tub outlet directly to the trap, there will not be an overflow or inline stopper unless other external means are used.
5. Plan the faucet location, either wall or floor mount. The faucet may be either roughed-in or fully installed before tub installation. The faucet may be located anywhere around the tub perimeter, depending on user preference and site conditions.
6. Move the Ofuro into location and place on blocks at each end. Use two 36" 4x12's on edge, or similar.
7. Glue the drain pipe stub into the integral drain coupling.
8. Removing the blocks, carefully lower the tub to the floor surface.
9. Complete drain connections, faucet connections, and finish flooring.



STANDARD PRODUCTS

SONOMA CAST STONE CORPORATION
877.283.1897 • www.sonomastone.com



For more product info, or to download replacement forms, see: www.sonomastone.com

DoubleWaveTub WV-TUB-DB

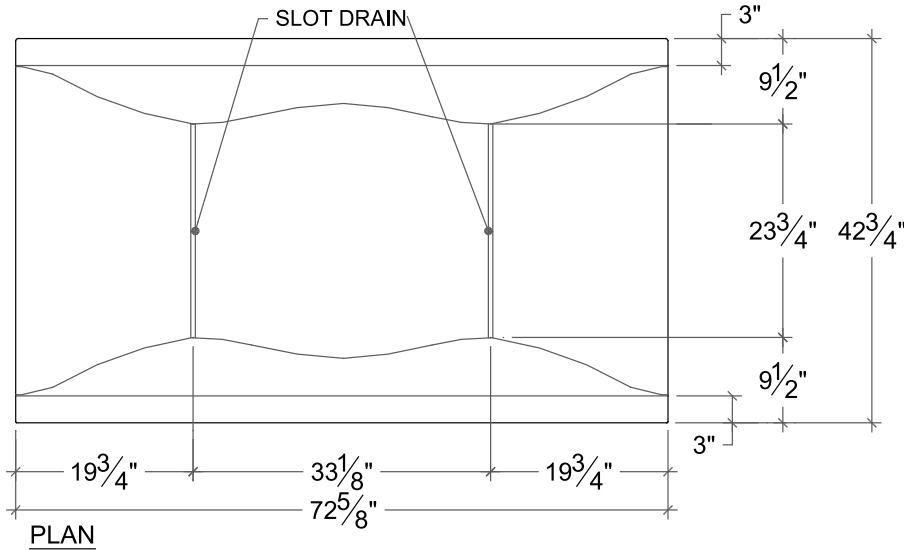

For remodel applications, platform framing may be necessary to accommodate plumbing. capacity: 130 gallons

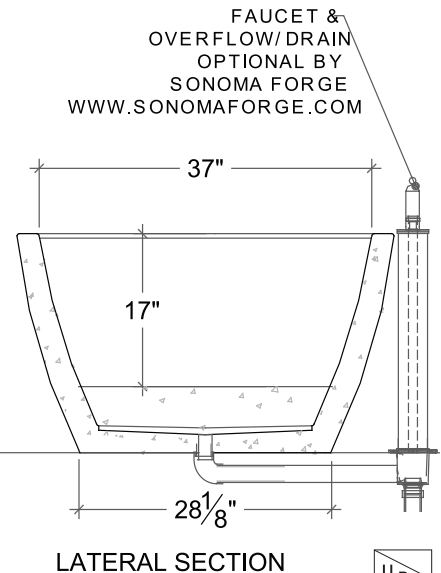
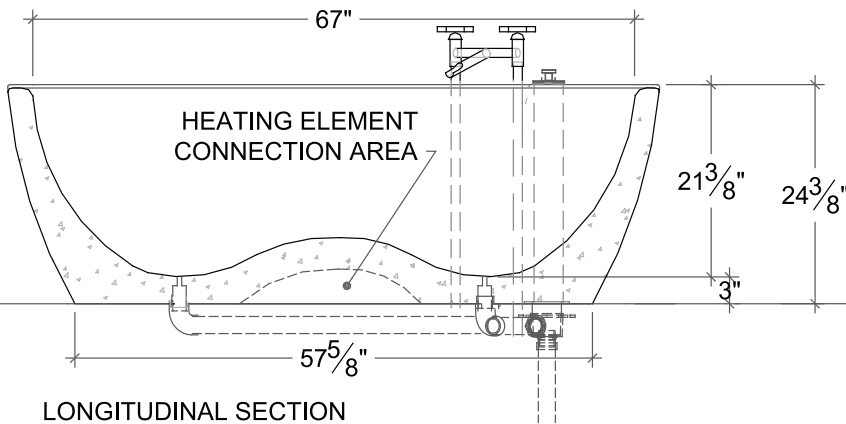

Designs ©2007 Sonoma Cast Stone Corp. All rights reserved.

Visit www.sonomastone.com to see photos of this and other products.



DESCRIPTION

Any body... and everybody can find the exact "right position" in this contoured double WaveTub. This beautiful stand alone tub has been called more of a piece of sculpture than a bathtub. An optional heating element can be embedded into the concrete to insure an even and constantly warm surface that will maintain the hot water until all of your daily woes are forgotten. The heating option includes a programmable timer that will control both the times and temperature of the tub surface. This large 1800 lb tub requires careful planning with an architect or structural engineer. Primarily designed for new construction, however, retrofit options are possible. An installation brochure should be requested and studied to insure that proper plumbing and electrical connections are in the proper placement before the floor is constructed.

Sonoma Forge has designed a tub filler and a combination drain and overflow assembly to match this tub.

FACTS

24 standard colors. See: www.sonomastone.com, catalog or techbinder. Custom colors available. Order samples online, or call 877-283-2400 x113.

Tub may be floor-mounted or on pedestal (raised floor) in remodel applications. 130 gallon capacity.

The slot drain couples to conventional 1-1/2" drain assemblies. 1-1/2" diameter ABS pipe stub-out included. 1-1/2" drain pipe must be accompanied with remote overflow & drain assembly (available from Sonoma Forge and others). Drain is best accomplished before floor is poured and completed.

For UPC (IAPMO) listing, see Appendix, p08-10.

Approximate Weight: 1,800 lbs / Crated 2,400 lbs

SEE WWW.SONOMASTONE.COM FOR PHOTOS AND ADDITIONAL INFORMATION ON THIS PRODUCT



STANDARD PRODUCTS

SONOMA CAST STONE CORPORATION
877.283.2400 • www.sonomastone.com



For more product info, or to download replacement forms, see: www.sonomastone.com

Floor Mount Tub Filler (35")

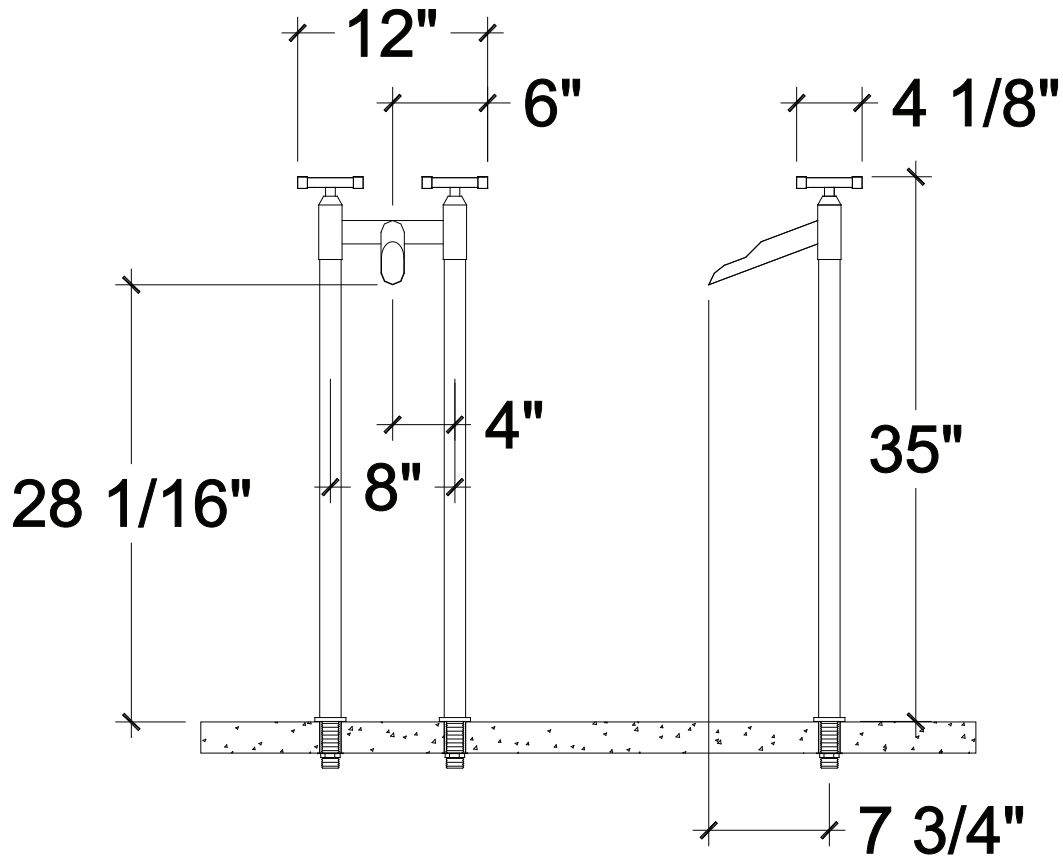

Designs ©2007 Sonoma Cast Stone Corp. All rights reserved.

Visit www.sonomastone.com to see photos of this and other products.



SEE WWW.SONOMASTONE.COM FOR PHOTOS AND ADDITIONAL INFORMATION ON THIS PRODUCT

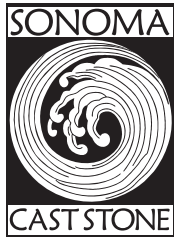

INSTALLATION

SONOMA CAST STONE CORPORATION
888.807.9117 www.sonomastone.com



For more product info, or to
download replacement forms,
see: www.sonomastone.com

Double Wave Soaking Tub

DOUBLE WAVE TUB INSTALLATION PROCEDURES (See Previous Page for Drawings)

PLANNING

This tub is both heavy and fragile. Careful planning is required for a successful installation. The WaveTub weighs 1870 uncrated. When full the 130 gallons will add an additional 1085 lbs. This total of 3010 lbs (includes two average adults) requires an adequate support structure. The contact surface is 11.26 square feet or approximately 263 lbs/ square foot. It is advised that an architect or structural engineer be consulted to ensure that the intended location will support this load.

The tub is 42" wide, therefore any doorway or other restriction leading to the installation location must accommodate this dimension. Since the tub tapers, a dolly or lift of no greater than this dimension may be used. If needed, the tub may be turned on its side (with proper support) and can then be taken through a restriction of 25" wide. If this limited dimension is required please notify the factory so that the tub can be crated to meet this restriction.

This tub is available Standard or with these options:

- Integral Heating Element
- With remote drain/ overflow

INSTALLATION

The installation varies slightly with each option selected. These instructions will serve a tub with all options. The installer can ignore sections that do not conform to the selected tub. There are four connection points that must be considered and access must be available to all four. All attachments to the WaveTub are accessed from under the tub.

1. Input water. In all cases the volume and temperature controls are separate and apart from the tub structure. To control the flow and temperature of the incoming water, either a wall mount or a tower mount control must be considered. If a wall mount is used, care should be taken to make the controls within reach of the bather.
2. Drain water. The two WaveTub drains connect together, then run via a trap to an underfloor drain system usually found in a basement or crawl space as with most conventional tub installations. This drain line should be 1" or greater in diameter and should be installed in such a manner to allow for the proper fall of the drain water. Provisions must be made to include a drain "stopper" in the line before the trap. This is achieved by either installing overflow/ drain assembly or through a shut off valve located as close to the tub as possible. These valves may be either manual or electrical. If the overflow/ drain assembly is not being used, it is recommended to have a floor drain close to the tub to prevent damage in the event of an overflow. The preferred alternative is to incorporate a combination drain/ overflow (made by Sonoma Forge and others). Since water seeks its own level, the overflow/drain may be placed anywhere between the tub and the trap. When this system is used any overflow water will go directly down an invisible drain and a floor drain is not necessary.
3. Electrical. This 110 volt resistance heater (60 Hz, 840 watts) is the same type and manufacturer as the widely used underfloor radiant heat found in many contemporary homes. The thermostat should be mounted in a wall or a remote tower at least 6' away from the tub, 4' above the floor. The thermostat has an internal GFI for safety and can be programmed in the same manner as a household thermostat. For double safety, it is recommended that this line be attached to an additional GFI circuit breaker at the main electrical service panel. Two conduits should be run to the thermostat from the tub, one for the line voltage and the other for the sensor wire. These connect to junction box embedded into the bottom of the WaveTub. There is a temperature sensor cast into the body of the tub that will turn the heat on only as needed. The electrical work should be done by a qualified and licensed electrician.

If you have any questions or would like more detailed instructions please call technical support 707-283-1888, x114



INSTALLATION

SONOMA CAST STONE CORPORATION
888.807.9117 www.sonomastone.com



For more product info, or to download replacement forms, see: www.sonomastone.com

Double Wave Soaking Tub

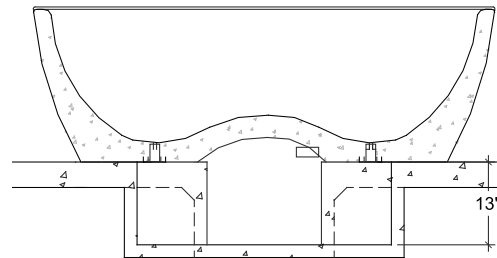
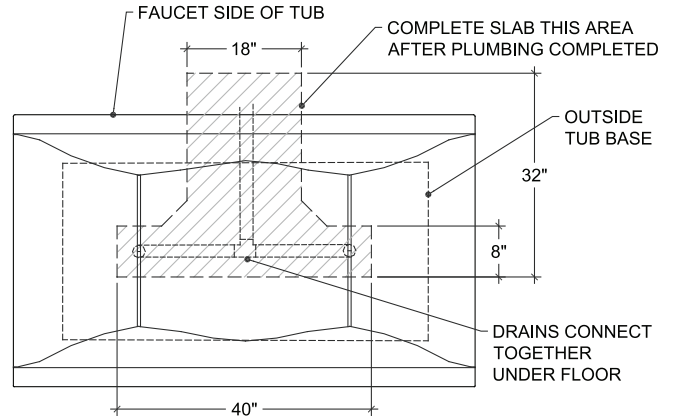

SUGGESTED SLAB ON GRADE ACCESS OPENING

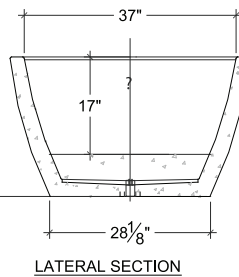
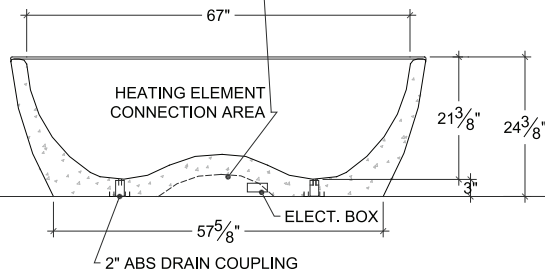
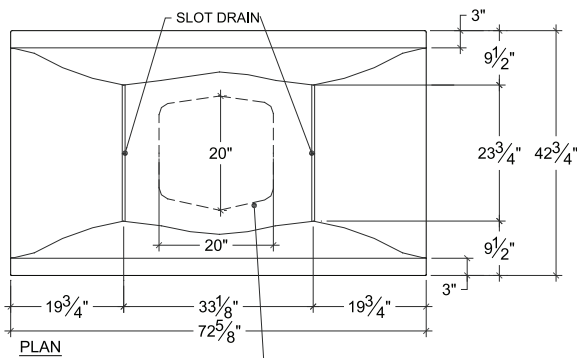

Designs © Sonoma Cast Stone Corp. 2007. All rights reserved.



INSTALLATION

SONOMA CAST STONE CORPORATION
(877) 283-2400 www.sonomastone.com



For more product info, or to
download replacement forms,
see: www.sonomastone.com

Tub Heating Elements

ELECTRICAL REQUIREMENTS FOR OFURO AND DOUBLE WAVE TUB WITH INTEGRAL HEATING ELEMENTS

General Requirements

1. The work should be performed by a qualified, licensed electrician.
2. Always follow local and national electrical codes.
3. A large grounded metal wall box is recommended for the (line voltage) thermostat. This should be at least 6' away from the tub, 4' above the floor.
4. Run 2 conduits from under the tub to the wall box. The 2nd one is for the temperature sensor wire.
5. Power to the wall box should be a dedicated GFI circuit.

OFURO Heating Element: 120 Volt AC
60Hz
480 watts

WV-TUB-DB Heating Element: 120 Volt AC
60 Hz
840 watts